

BOILER SAFETY UNITS

SG 50
SG 100
SG 200
SG 350

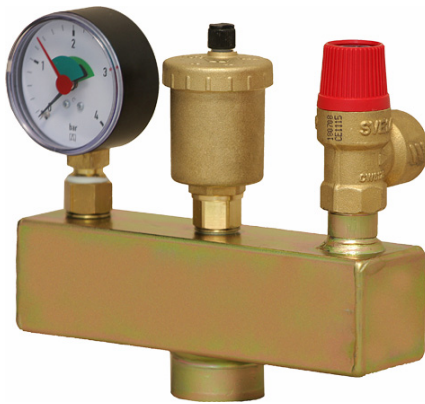

up to 350 kW

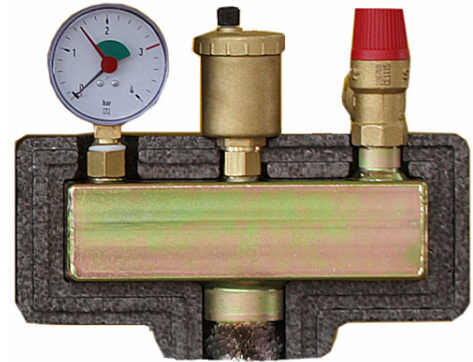

Boiler safety units

R 1/2" (SG 50)
R 3/4" (SG 100)
R 1" (SG 200)
R 5/4" (SG 350)

- ❑ Mounting assembly for self-contained heating systems
- ❑ Connection coupling 1" (5/4" for SG 350)
- ❑ Ready for use - equipped with:
 - ❑ Manometer Ø63 mm/4 bar/3/8" with automatic shut-off valve
 - ❑ 3/8" quick air bleeding system with automatic shut-off valve
 - ❑ Safety valve:
 - 1/2" 2.5 bar or 3 bar for systems up to 50 kW
 - 3/4" 2.5 bar or 3 bar for systems up to 100 kW
 - 1" 2.5 bar or 3 bar for systems up to 200 kW
 - 5/4" 2.5 bar or 3 bar for systems up to 350 kW
- ❑ Galvanised steel chamber
- ❑ Insulation to DIN 4102-B2 standard

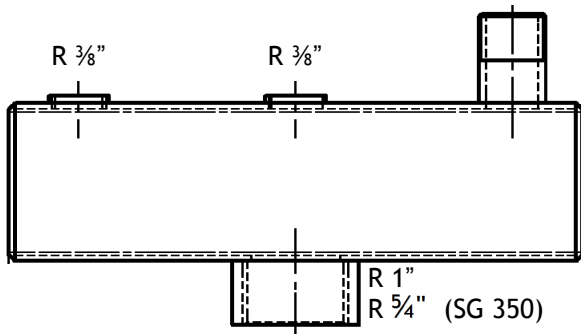

MIK Boiler safety units SG with insulation



- ❑ Connection coupling R 1" (R 5/4" SG 350)
- ❑ Ready for use - equipped with:
 - Manometer Ø63 mm/4 bar/3/8"
 - 3/8" quick air bleeding system
 - Safety valve
- ❑ Galvanised steel mounting
- ❑ Insulation to DIN 4102-B2 standard

Type	Safety valve	Product No.
SG/I 50	1/2"	860 050
SG/I 100	3/4"	860 100
SG/I 200	1"	860 200
SG/I 350	5/4"	860 350

MIK Steel chamber for boiler safety unit SG



Type	Safety valve	Product No.
K2a (SG 50)	R 1/2"	860 212
K3a (SG 100)	R 3/4"	860 213
K4a (SG 200)	R 1"	860 214
K5a (SG 350)	R 5/4"	860 215

SG 50 can be combined with type **HVT** heating manifolds.

